

# Installation Instructions 安裝說明書

FUEL TANK SKID PLATE

汽油箱下護板

#Q0765

## Application 適用車型

Suzuki Jimny 4th '18-

## Components 內含配件

- ① Fuel Tank Skid Plate 油箱護板.....1pcs
- ② Bracket 固定支架(前/側/後).....3pcs
- ③ Bolt 螺絲 (M8x1.25x16).....5pcs
- ④ Bolt 螺絲 (M8x1.25x25).....2pcs

## Caution 注意事項

- Installation is recommended to be performed by licensed mechanics with necessary tools to ensure safety. Incorrect installation may cause injury, damage to the product or vehicle. 安裝建議由合格的技師及工具執行以確保安全。安裝錯誤可能對人員、產品及車輛造成傷害。
- Note the routing of wires and cables before installation, or please refer to factory manual. 安裝前請事先記下線路的安裝路徑及位置以維持原廠配置。有疑問時請參考原廠手冊。
- Tighten bolts and nuts firmly by using handtools, and with specified torque if mentioned. 安裝過程請使用手動工具確實鎖緊螺帽及螺絲。如有特別註明請依照說明指示的扭力上鎖。

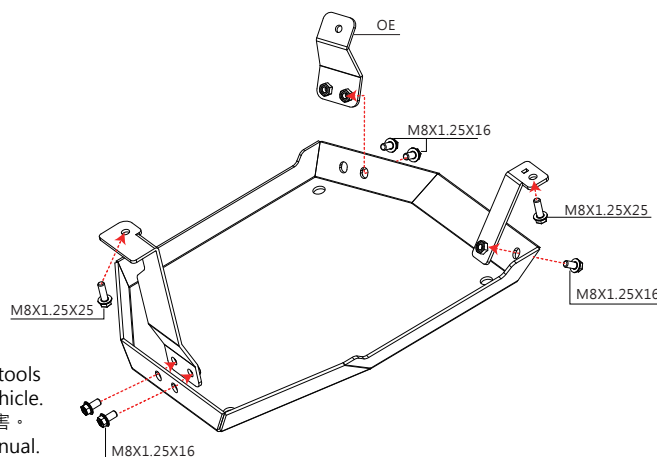

## Instructions 安裝說明

1. Install the front bracket using M8x1.25x16 Hex head bolt screw in right next to the hand brake cable.

前端固定支架安裝方式手剎車線固定位置。安裝前端支架使用外六角螺絲 M8x1.25x25 取代下方護板鎖點使用 M8x1.25x16 外六角螺絲。



2. Using the OE bolt to hold the side bracket. At the connecting point of skid plate and the bracket use the M8x1.25x16 Hex head bolt. 側邊固定支架安裝方式先將原廠OE螺絲拆卸把支架安裝。上端沿用OE螺絲下端使用M8x1.25x16外六角螺絲X2。



3. The rear bracket is using the M8x1.25x26 Hex head bolt at the connecting point of skid plate and bracket. The upper connecting point using M8x1.25x25 to hold the bracket.

後端安裝方式將油箱後端固定螺絲拆卸安裝支架。上端螺絲使用 M8x1.25x25 外六角螺絲 下端使用 M8x1.25x26 外六角螺絲 X2。



Illustration of installed state 安裝完成示意圖