

Installation Instructions

安裝說明書

BRAKE MASTER CYLINDER STOPPER

剎車總泵頂桿

#Q0363

Application 適用車型

HONDA CIVIC '12-16 FB

For LHD models 左駕車型適用

Components 內含配件

① Bracket 支架.....	1pcs
② Bolt 螺絲 (M6x1.0x25).....	3pcs
③ Rubber A 橡皮 A.....	1pcs
④ Rubber B 橡皮 B.....	1pcs
⑤ Nut 螺帽 (M10x1.25-14x9.5).....	3pcs
⑥ Bolt 螺絲 (M10x1.25x20).....	1pcs
⑦ Extension nut 加長桿.....	1pcs

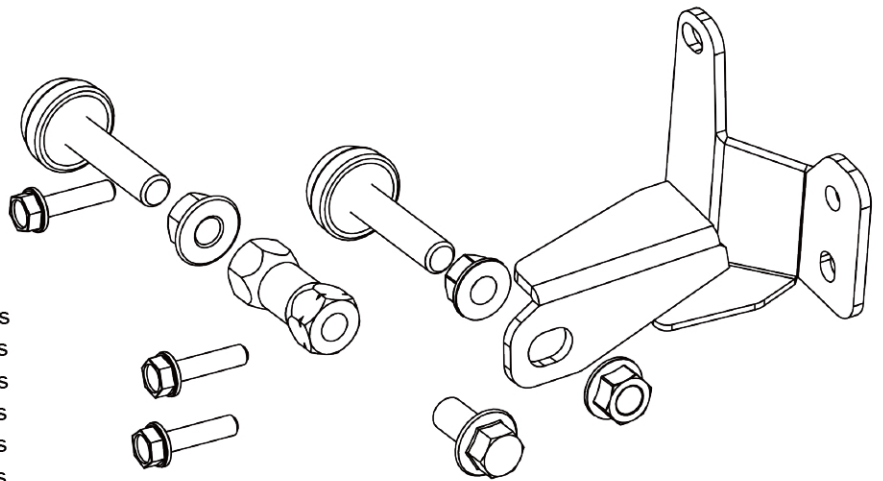

Caution 注意事項

- Installation is recommended to be performed by licensed mechanics with necessary tools to ensure safety. Incorrect installation may cause injury, damage to the product or vehicle.
安裝建議由合格的技師及工具執行以確保安全。安裝錯誤可能對人員、產品及車輛造成傷害。
- Note the routing of wires and cables before installation, or please refer to factory manual.
安裝前請事先記下線路的安裝路徑及位置以維持原廠配置。有疑問時請參考原廠手冊。
- Tighten bolts and nuts firmly by using handtools, and with specified torque if mentioned.
安裝過程請使用手動工具確實鎖緊螺帽及螺絲。如有特別註明請依照說明指示的扭力上鎖。

Instructions 安裝說明

1. Install supplied rubber to the bracket. The two orientations are for different types of brake master cylinders.
請參考配件圖。先將橡皮安裝於頂桿支架上。安裝方式分為兩種。以適用不同的煞車總泵配置。
2. Remove the whole air filter box to access brake master cylinder.
將空氣濾清器拆下後即可找到煞車總泵。



Illustration of installed state
安裝完成示意圖

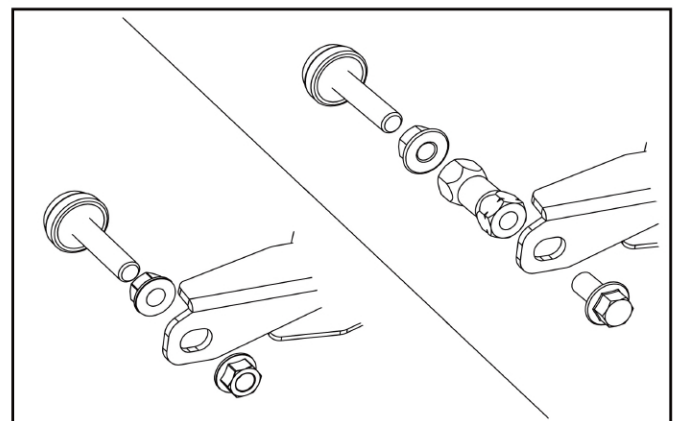

3. Remove the three bolts to install bracket.
將三個螺絲卸下後安裝支架。
4. Install supplied bolts to secure the bracket.
完成後鎖上配件螺絲以固定支架。
5. Adjust the nuts until the rubber contacts the brake master cylinder.
調整螺帽。使橡皮部分支撐於剎車總泵。